

PT

Disponíveis modelos com ou sem porta de correr; com ou sem prateleira e com ou sem prateleira com escorredor. A linha é constituída de diversos modelos; é possível variar a medida padrão alterando de 10 em 10 cm e duas alturas, 67 e 90 cm. Estrutura em aço inox AISI 304 18/10; toda a linha é projetada para atender os mais diversos tipos de trabalho.

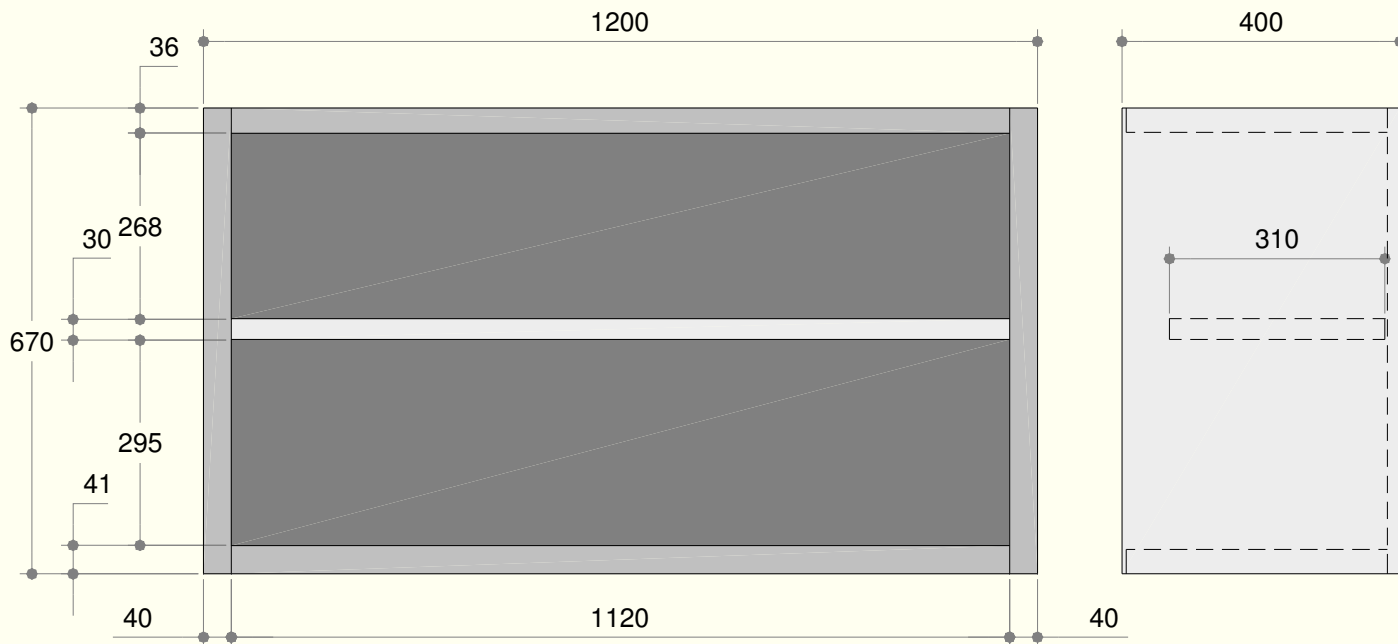

**PPSN0005**



**PPSN0018**

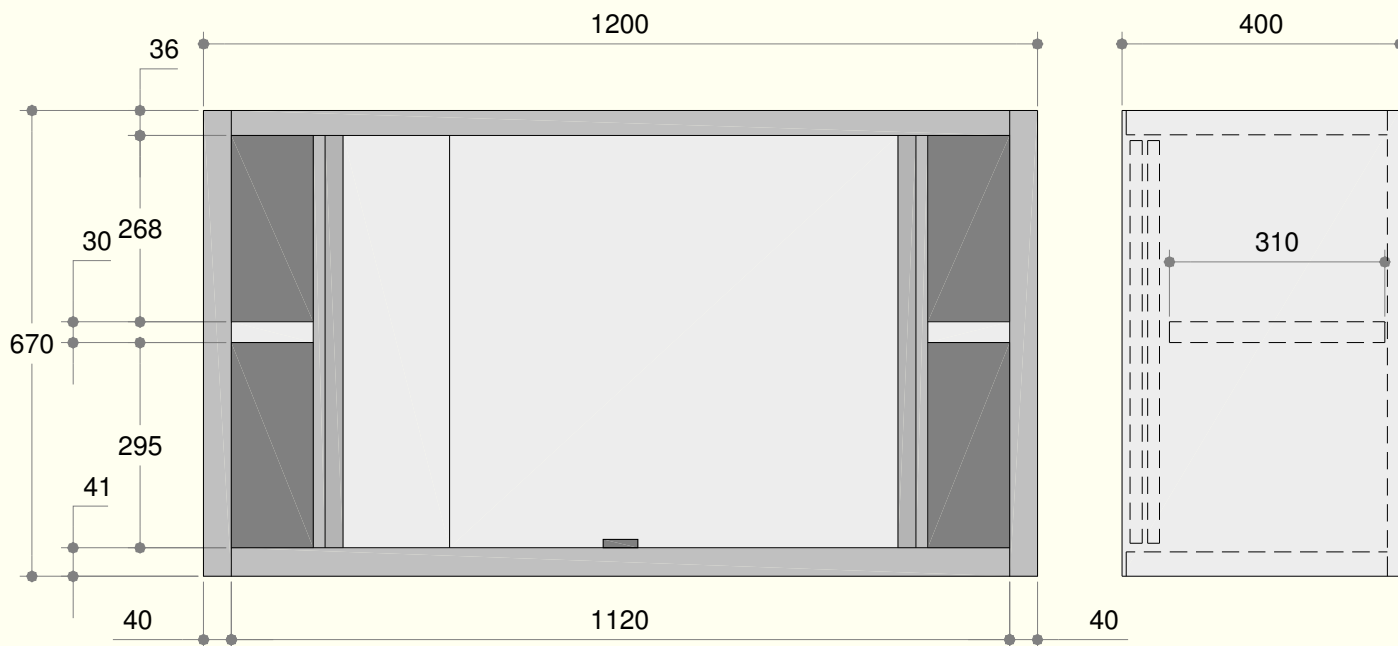

PPSN0031

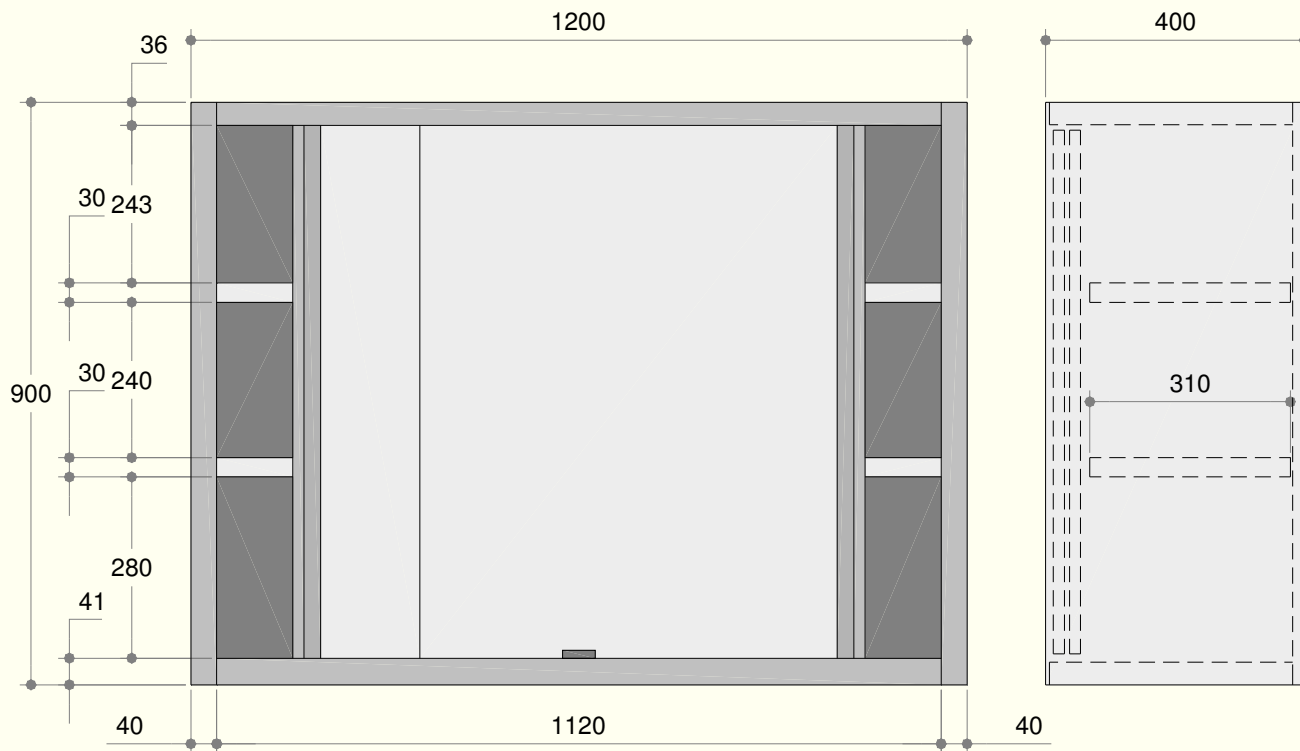

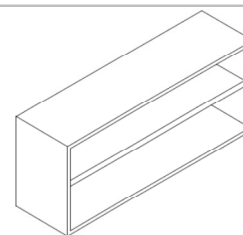
**Armário suspenso**  
 Open Hanging Units

| Modelo - Model       | Dimensões externas - External Dimension |                      |                            |                  | H=67                       |
|----------------------|---|----------------------|----------------------------|------------------|----------------------------|
|                      | Material                                | Comprimento<br>Width | Profundidade<br>e<br>Depth | Altura<br>Height | Peso líquido<br>Net weight |
|                      |   | mm                   | mm                         | mm               | kg                         |
| PPSN0001<br>68251301 | 304                                     | L=800                | 400                        | 670              |                            |
| PPSN0002<br>68251302 |   | L=900                |                            |                  |                            |
| PPSN0003<br>68251303 |   | L=1000               |                            |                  |                            |
| PPSN0004<br>68251304 |   | L=1100               |                            |                  |                            |
| PPSN0005<br>68251305 |   | L=1200               |                            |                  |                            |
| PPSN0006<br>68251306 |   | L=1300               |                            |                  |                            |
| PPSN0007<br>68251307 |   | L=1400               |                            |                  |                            |
| PPSN0008<br>68251308 |   | L=1500               |                            |                  |                            |
| PPSN0009<br>68251309 |   | L=1600               |                            |                  |                            |
| PPSN0010<br>68251310 |   | L=1700               |                            |                  |                            |
| PPSN0011<br>68251311 |   | L=1800               |                            |                  |                            |
| PPSN0012<br>68251312 |   | L=1900               |                            |                  |                            |
| PPSN0013<br>68251313 |   | L=2000               |                            |                  |                            |

**1 Prateleira ajustável - 1 Adjustable Shelf**

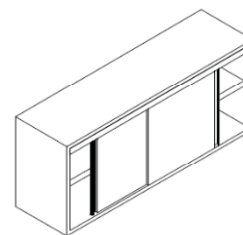
**Armário suspenso com porta de correr**  
 Hanging Units with Sliding Doors

| Modelo - Model       | Dimensões externas - External Dimension |                      |                            |                  | H=67                       |
|----------------------|---|----------------------|----------------------------|------------------|----------------------------|
|                      | Material                                | Comprimento<br>Width | Profundidade<br>e<br>Depth | Altura<br>Height | Peso líquido<br>Net weight |
|                      |   | mm                   | mm                         | mm               | kg                         |
| PPSN0014<br>68252314 | 304                                     | L=800                | 400                        | 670              |                            |
| PPSN0015<br>68252315 |   | L=900                |                            |                  |                            |
| PPSN0016<br>68252316 |   | L=1000               |                            |                  |                            |
| PPSN0017<br>68252317 |   | L=1100               |                            |                  |                            |
| PPSN0018<br>68252318 |   | L=1200               |                            |                  |                            |
| PPSN0019<br>68252319 |   | L=1300               |                            |                  |                            |
| PPSN0020<br>68252320 |   | L=1400               |                            |                  |                            |
| PPSN0021<br>68252321 |   | L=1500               |                            |                  |                            |
| PPSN0022<br>68252322 |   | L=1600               |                            |                  |                            |
| PPSN0023<br>68252323 |   | L=1700               |                            |                  |                            |
| PPSN0024<br>68252324 |   | L=1800               |                            |                  |                            |
| PPSN0025<br>68252325 |   | L=1900               |                            |                  |                            |
| PPSN0026<br>68252326 |   | L=2000               |                            |                  |                            |

**1 Prateleira ajustável - 1 Adjustable Shelf**

**Armário suspenso com porta de correr**

Hanging Units with Sliding Doors

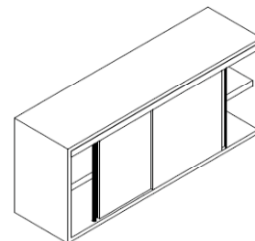

| Modelo - Model       | Dimensões externas - External Dimension |                             |                              |                         | H=90                              |
|----------------------|---|-----------------------------|------------------------------|-------------------------|-----------------------------------|
|                      | <br><b>Material</b>                     | <b>Comprimento</b><br>Width | <b>Profundidade</b><br>Depth | <b>Altura</b><br>Height | <b>Peso líquido</b><br>Net weight |
|                      |   | mm                          | mm                           | mm                      | kg                                |
| PPSN0027<br>68252327 | 304                                     | L=800                       | 400                          | 900                     |                                   |
| PPSN0028<br>68252328 |   | L=900                       |                              |                         |                                   |
| PPSN0029<br>68252329 |   | L=1000                      |                              |                         |                                   |
| PPSN0030<br>68252330 |   | L=1100                      |                              |                         |                                   |
| PPSN0031<br>68252331 |   | L=1200                      |                              |                         |                                   |
| PPSN0032<br>68252332 |   | L=1300                      |                              |                         |                                   |
| PPSN0033<br>68252333 |   | L=1400                      |                              |                         |                                   |
| PPSN0034<br>68252334 |   | L=1500                      |                              |                         |                                   |
| PPSN0035<br>68252335 |   | L=1600                      |                              |                         |                                   |

**2 Prateleiras ajustáveis - 2 Adjustable Shelves**

**Armário suspenso com escorredor**

Hanging Units with Draining Board

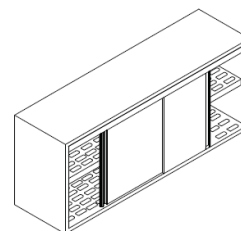

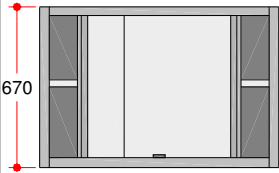
| Modelo - Model  |          | Dimensões externas - External Dimension |                           |                  | H=67                       |
|---|----------|---|---------------------------|------------------|----------------------------|
|  | Material | Comprimento<br>Width                    | Profundidad<br>e<br>Depth | Altura<br>Height | Peso líquido<br>Net weight |
|   |          | mm                                      | mm                        | mm               | kg                         |
| PPSG0001<br>68253301  | 304      | L=800                                   | 400                       | 670              |                            |
| PPSG0002<br>68253302  |          | L=1000                                  |                           |                  |                            |
| PPSG0003<br>68253303  |          | L=1200                                  |                           |                  |                            |
| PPSG0004<br>68253304  |          | L=1400                                  |                           |                  |                            |
| PPSG0005<br>68253305  |          | L=1600                                  |                           |                  |                            |
| PPSG0006<br>68253306  |          | L=1800                                  |                           |                  |                            |
| <b>2 Prateleiras com escorredor - 2 Draining Boards</b>                           |          |   |                           |                  |                            |

**Armário suspenso com escorredor**

Hanging Units with Draining Board

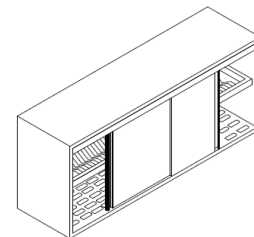

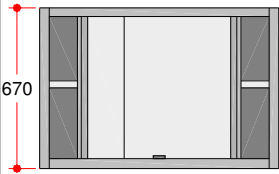

| Modelo - Model  |          | Dimensões externas - External Dimension |                           |                  | H=67                       |
|---|----------|---|---------------------------|------------------|----------------------------|
|              | Material | Comprimento<br>Width                    | Profundidad<br>e<br>Depth | Altura<br>Height | Peso líquido<br>Net weight |
|   |          | mm                                      | mm                        | mm               | kg                         |
| PPSS0001<br>68253321  | 304      | L=800                                   | 400                       | 670              |                            |
| PPSS0002<br>68253322  |          | L=1000                                  |                           |                  |                            |
| PPSS0003<br>68253323  |          | L=1200                                  |                           |                  |                            |
| PPSS0004<br>68253324  |          | L=1400                                  |                           |                  |                            |
| PPSS0005<br>68253325  |          | L=1600                                  |                           |                  |                            |
| PPSS0006<br>68253326  |          | L=1800                                  |                           |                  |                            |
| <b>1 Prateleira com escorredor + 1 escorredor de prato - 1 Draining Board + 1 Plate-Racks</b> |          |   |                           |                  |                            |

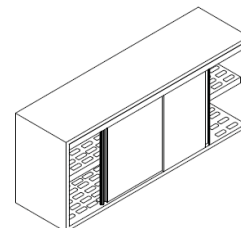

**Armário suspenso com escorredor**

Hanging Units with Draining Board

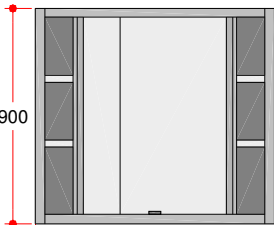

| Modelo - Model  |  Dimensões externas - External Dimension | H=90                 |                       |                  |                            |
|---|---|----------------------|-----------------------|------------------|----------------------------|
|  900 | Material  | Comprimento<br>Width | Profundidade<br>Depth | Altura<br>Height | Peso líquido<br>Net weight |
|   |   | mm                   | mm                    | mm               | kg                         |
| PPSG0007<br>68253307  | 304   | L=800                | 400                   | 900              |                            |
| PPSG0008<br>68253308  |   | L=1000               |                       |                  |                            |
| PPSG0009<br>68253309  |   | L=1200               |                       |                  |                            |
| PPSG0010<br>68253310  |   | L=1400               |                       |                  |                            |
| PPSG0011<br>68253311  |   | L=1600               |                       |                  |                            |
| <b>3 Prateleiras com escorredor - 3 Draining Boards</b>                               |   |                      |                       |                  |                            |